

Product data sheet

Characteristics

VW3A1102

door mounting kit, Altivar, variable speed drive, for remote graphic terminal, IP54

Product availability : Stock - Normally stocked in distribution facility



Main

Range of product	Altivar
Accessory / separate part category	Mounting and fixing accessory
Accessory / separate part type	Mounting kit
Accessory / separate part destination	Variable speed drive
Range compatibility	Altivar 71 Altivar 71Q Altivar 32 Altivar 61 Altivar 212 Altivar 61Q Altivar Machine ATV320
IP degree of protection	IP54

Complementary

Kit composition	Screws and bolts for mounting Mounting hardware
Net Weight	0.33 lb(US) (0.15 kg)

Ordering and shipping details

Category	22135 - ATV61-71 ACCESSORIES
Discount Schedule	CP4C
GTIN	00785901684985
Nbr. of units in pkg.	1
Package weight(Lbs)	0.46 lb(US) (0.21 kg)
Returnability	Yes
Country of origin	FR

Packing Units

Unit Type of Package 1	PCE
Package 1 Height	2.95 in (7.5 cm)

* Price is "List Price" and may be subject to a trade discount – check with your local distributor or retailer for actual price.

Package 1 width	6.50 in (16.5 cm)
Package 1 Length	9.06 in (23 cm)
Package 2 Weight	4.49 lb(US) (2.037 kg)
Package 3 Weight	58.72 lb(US) (26.636 kg)

Offer Sustainability

California proposition 65	WARNING: This product can expose you to chemicals including: Lead and lead compounds, which is known to the State of California to cause cancer and birth defects or other reproductive harm. For more information go to www.P65Warnings.ca.gov
REACH Regulation	REACH Declaration
REACH free of SVHC	Yes
EU RoHS Directive	Pro-active compliance (Product out of EU RoHS legal scope) EU RoHS Declaration
Mercury free	Yes
RoHS exemption information	Yes
China RoHS Regulation	China RoHS declaration

Contractual warranty

Warranty	18 months
----------	-----------

Door Mounting Kit for Remote Graphic Display Terminal

Dimensions and Mounting

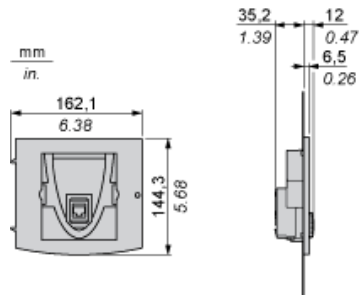

Cuts-outs and drill holes

